



CITY OF TAMPA

Pam Iorio, Mayor

CONTRACT ADMINISTRATION DEPARTMENT

David L. Vaughn, AIA, Director

ADDENDUM NO. 5

DATE: December 30, 2009

Project: Springhill Park Community Center
Project No. 7-C-59

Bidders on the above referenced project are hereby notified that the following addendum is made to the Contract Documents. BIDS TO BE SUBMITTED SHALL CONFORM TO THIS NOTICE.

- Item 1: Specification Section 15180 CLARIFICATION; All air conditioned supply and return ducts in concealed areas shall be insulated. In exposed areas such as mechanical rooms, ducts shall be insulated with fiberglass rigid insulation board.
- Item 2: Specification Section 15840 CLARIFICATION; Exposed ductwork in the Gymnasium shall be as follows:
Rectangular - double wall
Round - 1" fiberglass insulation sandwiched between inner liner and outer shell.
- Item 3: Sheets E-5 and E-5A LIGHTING PLAN; Fixture 'N' REVISION: In lieu of light fixture 'N' with a total quantity of 24 for the Gymnasium space, provide 40 fixtures as manufactured by Stonco/Crescent. Contractor shall confirm that existing circuiting as shown will accommodate lighting; or identify additional circuits as required. Refer to attached Drawing No. AP09340D.AGI, showing revised layout.
- Item 4: Specification Section 09680 REVISE AS FOLLOWS; REPLACE, on page 09680 – 5, Carpet Designation: MOHAWK SUPERTRON SD-49445 with BIGELOW STATI-TUFT III MODULAR as a basis of design for carpet tiles in this project where indicated.
- Item 5: Sheet A-1.3, Detail 3; CLARIFICATION: SEE Attached SK-1 for clarification of footing detail for 4 X 4 tube steel base plate for the baseball dugouts. Also see 8/S-8 for HSS Base Plate detail.

This addendum shall be included in and attached to the inside cover of the Contract Documents by and upon which bids are submitted. All other provisions of the Contract Documents and Specifications not in conflict with this Addendum shall remain in full force and effect.

Questions are to be e-mailed to ContractAdministration@tampagov.net.

Jim Greiner

Jim Greiner, P.E., Contract Manager

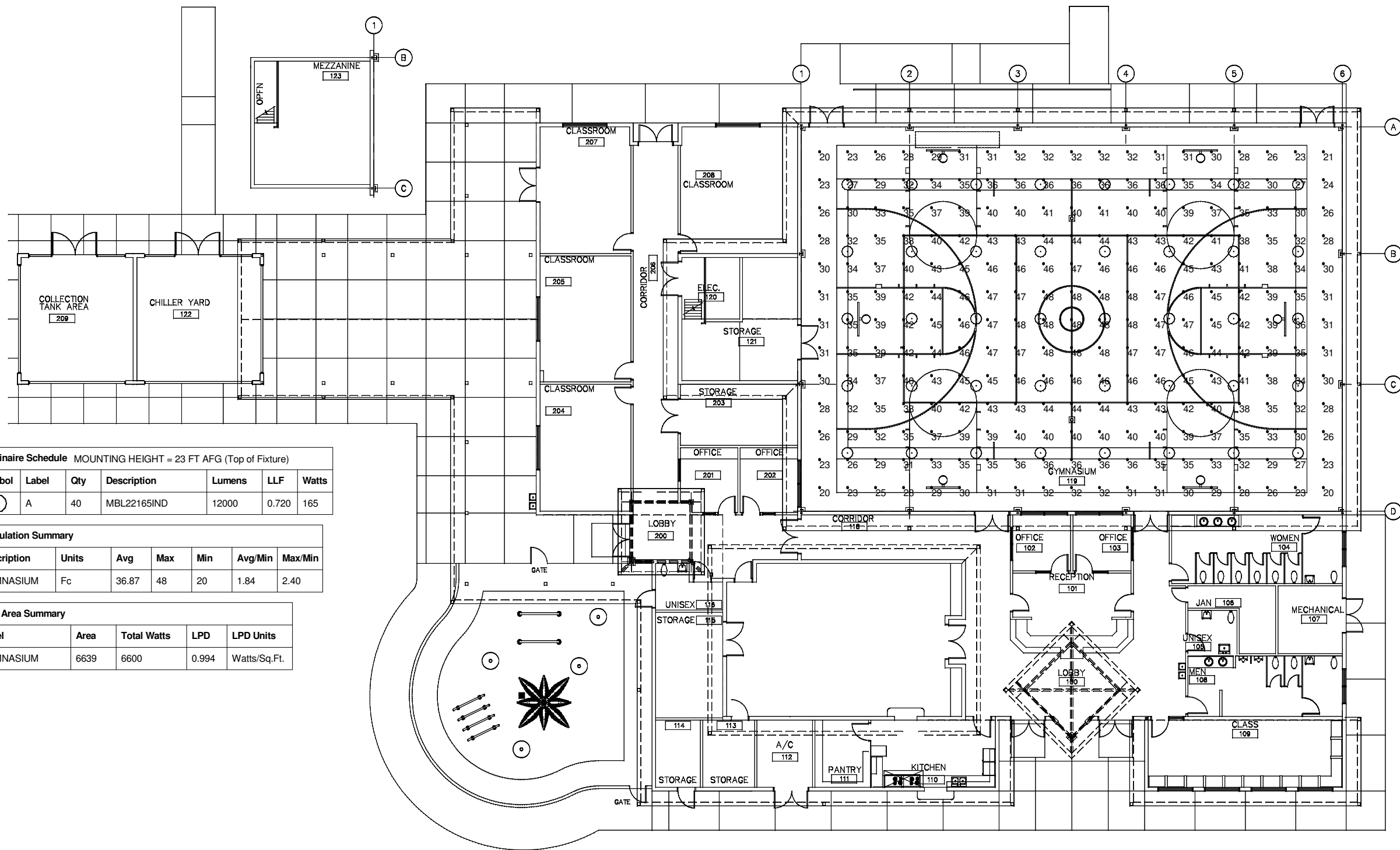

Luminaire Schedule MOUNTING HEIGHT = 23 FT AFG (Top of Fixture)

Symbol	Label	Qty	Description	Lumens	LLF	Watts
⊙	A	40	MBL22165IND	12000	0.720	165

Calculation Summary

Description	Units	Avg	Max	Min	Avg/Min	Max/Min
GYMNASIUM	Fc	36.87	48	20	1.84	2.40

LPD Area Summary

Label	Area	Total Watts	LPD	LPD Units
GYMNASIUM	6639	6600	0.994	Watts/Sq.Ft.



applications engineering

2345 VAUXHALL ROAD UNION, NJ 07083 908-964-7000

SCALE: 1" = 20' - 0"
 DRAWN BY: F. GARZA
 DATE: OCTOBER 1, 2009

Photometric data used in this design is based on industry procedures and tested in laboratory conditions. Field performance may differ from predicted values due to normal deviations in the luminaire installation, electrical supply, equipment tolerances and/or obstructions within the lighted area and are not the responsibility of CrescentStoneco or the Gentyle Thomas Group.
 Light Loss Factor is based on Lamp Lumen Depreciation times Luminaire Dirt Depreciation.
 All Values are in Footcandles.

PROPOSED ILLUMINATION PLAN FOR:
SPRINGHILL COMMUNITY CENTER
 1000 Eskimo Ave
 Tampa, FL
LIGHTING PLAN

DRAWING NO.
 AP09340D.AGI

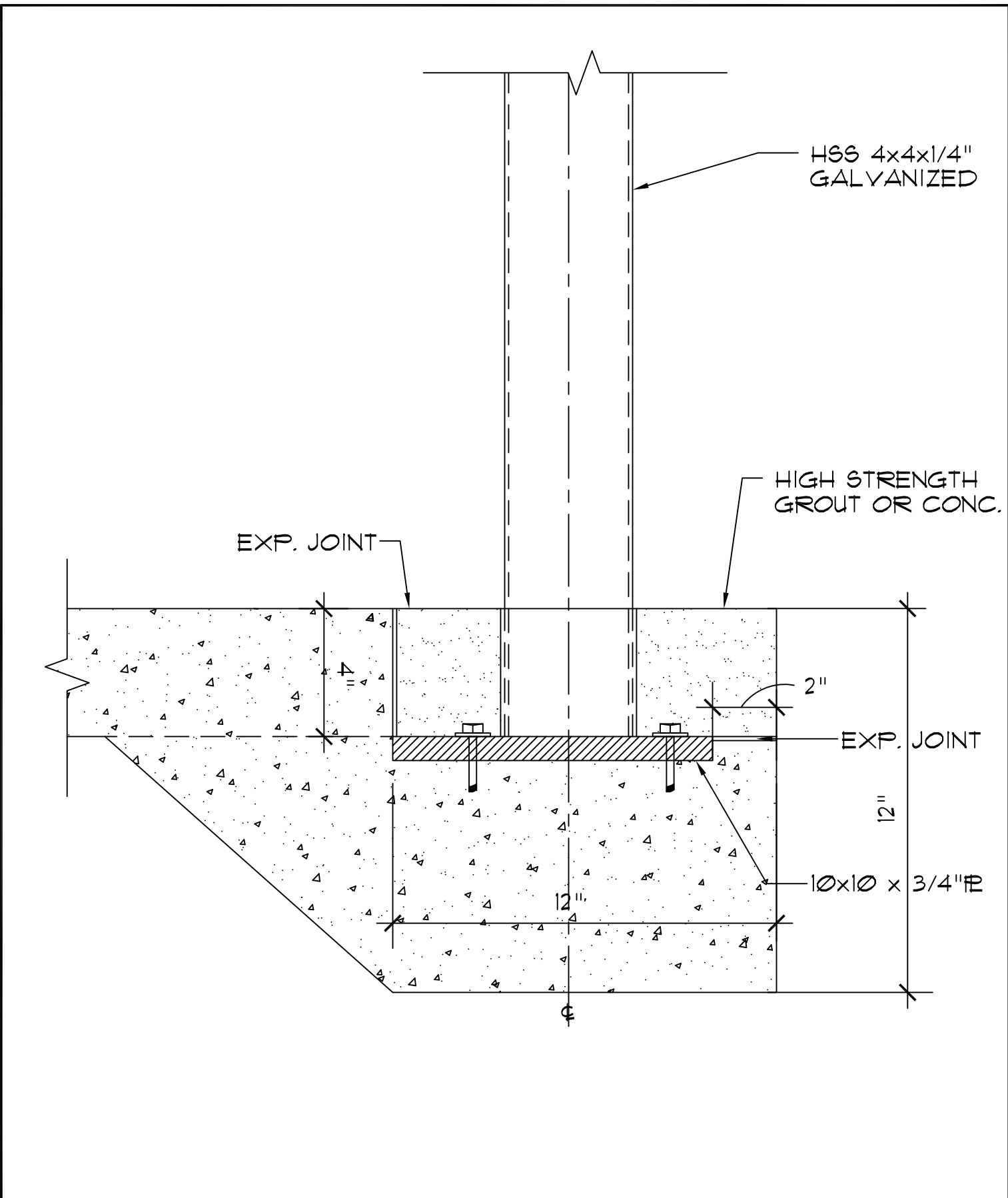

CITY OF TAMPA
 CONTRACT ADMINISTRATION DEPARTMENT
 PLANNING AND DESIGN DIVISION

PROJECT LOCATION
 1000 E. ESKIMO AVENUE TAMPA, FLORIDA 33604

PROJECT DESCRIPTION
 SPRINGHILL COMMUNITY CENTER

DATE: 12/29/09

DRAWN BY: JPS

SK-1

ARCHITECT: THOMAS HESTER

SCALE: 3"=1'-0"

___ of ___