

PLEASE READ CAREFULLY

Your application for water/sewer service must be filled out completely. Legal description must be on the application including lot and block or metes & bounds.

The name that is put on the top on application will be the name the utility account will be started under. If you are sub-dividing a lot please include site plan or other documentation showing actual building area.

Make sure the address of the property is included on the application (see service address of proposed sites on application).

If above information is not on your application it could result in improper calculations of water/sewer fees. Subdivided lots are subject to aid-in-construction costs for sewer.

AFTER WATER CONNECTION FEES ARE PAID IT WILL TAKE APPROXIMATELY FOUR (4) WEEKS FOR THE METER INSTALLATION.



City of Tampa
Water Department
306 E. Jackson St, 5E
Tampa, FL 33602
Phone: (813) 274-8121

Dear Prospective Water Customer:

Thank you for contacting the City of Tampa Water Department for your water service needs. To ensure that your new water service is completed as quickly as possible, the following information applies:

1. It will be necessary to furnish a legal description of the property to be served with your application
2. The Water Department will determine the meter location. For single-family residences, the meter will be installed within two (2) feet of the side property line or as determined by the Water Department. For multiple residential units, the meter will be installed as determined by the Water Department. Irrigation meters will normally be installed adjacent to the existing domestic meter.
3. The meter installation shall not be damaged and the meter shall be accessible at all times.
4. The Tampa Water Department is responsible for installation of the meter only. You are responsible for connecting your piping to the pipe stub provided by the Water Department. A plumbing permit may be required to install the service pipe from your building to the meter.
5. No connections are allowed inside the meter boxes. All water meters, piping, and appurtenances from the main to the customer's side of the meter box are the property of the Tampa Water Department.
6. The Water Department is responsible for repairing leakage from the water main to inside the meter box. You are responsible for all leakage occurring on the customer's side of the meter box.
7. You may be required to install a backflow preventer. If so, you will be notified at a later date.
8. Fees shall be paid within 90 days of commitment to avoid cancellation. There is no refund of the application fee.

We are looking forward to having you as a customer. Once the fees have been paid it may take four (6) to six (8) weeks for routine water meter installations. Otherwise, it may take several months. Should you have any questions please call our representatives at (813) 274-8121, or visit the Downtown office at 306 E. Jackson St, 5th floor.

Sincerely,

Brad Baird, P.E.
Water Department Director

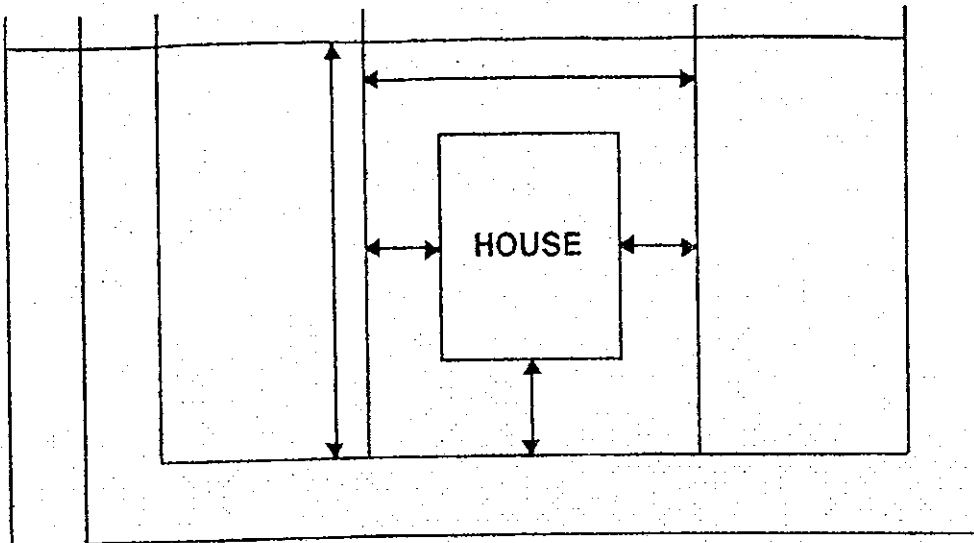

Name: _____
 Address: _____
 Phone: _____

SHOW DRIVEWAYS, FENCES AND OTHER OBSTRUCTIONS
 DESIGNATE NEAREST INTERSECTING STREETS & DIRECTION



WAT 152 (7/96)

Please show where you want the meter set.

IF THE METER IS INSTALLED IN THE DRIVEWAY
 THERE WILL BE A FEE TO RELOCATE.

(Indicate North Direction)



WATER METER APPLICATION INFORMATION

Please Fill Out The Following Before Payment of Fees

Applicant's Name: _____

Applicant's Address: _____

Service Address: _____ Tap No. _____

Reason for Purchasing Meter – *Please check one or more of the items below:*

New Construction Existing Building

Meter Replacement, old service

Meter Installation, new service

Additional Meter

Increasing Size of Meter

Well to City Water

I, the undersigned, understand that this meter installation will be subject to Sewer Capacity Fees, if in an area serviced by the City of Tampa Department of Sanitary Sewers. The average additional sewer fee is \$1,600. Please contact the Department of Sanitary Sewers, 6th Floor East, to determine what fees are due.

Signature: _____

Date: _____

Phone Number: _____

A WATER DEPARTMENT COMMITMENT WILL NOT BE ISSUED UNTIL THIS FORM IS COMPLETED



**CITY OF TAMPA
CONSTRUCTION SERVICES DIVISION
1400 NORTH BOULEVARD
TAMPA, FL 33607
PHONE: 259-1835**

**APPLICATION FOR COMMITMENT
WATER/WASTEWATER
SINGLE FAMILY RESIDENCE/SINGLE DUPLEX**
PLEASE TYPE OR PRINT CLEARLY

Submitting Date

NAME, ADDRESS, TELEPHONE NUMBER OF OWNER(S) OF PROPERTY:

PHONE NO. BUSINESS: _____
HOME: _____ HDC PROJECT NO.

NAME:

ADDRESS:

CITY, STATE, ZIP:

BILLING ADDRESS (IF DIFFERENT FROM ABOVE):

NAME OF CONTRACTOR/AUTHORIZED REPRESENTATIVE:

PHONE:

DRIVER'S LICENSE NO. (OWNER):

SOC. SEC. NO./FED. I.D. NO.

LEGAL DESCRIPTION:

TAX FOLIO NO.:

EXISTING _____ PROPOSED _____

INSIDE _____ OUTSIDE _____ CITY LIMITS

SUBDIV.:

BLK:

LOT:

SERVICE ADDRESS OF PROPOSED SITE:

ATLAS PAGE:

TAX EXEMPT?

NO. OF UNITS

WASTEWATER DEPARTMENT INFORMATION

DISTRICT	RCI CODE	ADJ LINE?	NEW TAP?	METERED/UNMETERED WELL	NO. OF PEOPLE	PRIV. PS
TAP REMARKS:					SERVICE ORDER NO.	MAP NO.
					PLUMBING RELEASE	SEWER IMPROVEMENT TYPE
					/ /	
REPRESENTATIVE GIVEN SEWER IMPROVEMENT SERVICE CHARGE FORM SI-5/SI-4/NA						DATE:
SIGNATURE OF REPRESENTATIVE:						

WATER DEPARTMENT INFORMATION

DATE WATER REQUIRED (BE SPECIFIC): REQUIRED POTABLE METER SIZE: IF EXISTING - CURRENT WATER SOURCE/SIZE METER

Applicant agrees that all necessary connection fees and charges will be at his expense in accordance with City of Tampa Ordinances. In addition, the applicant agrees that the water mains and appurtenances thereto, excluding those on the consumer's side and metered services, shall be the property of the City and that the same shall constitute a part of the water distribution system of the City and subject to all rules and regulations relating to the operation of the City of Tampa Water Department. Applicant understands that a NON-REFUNDABLE application fee is required. All money owed the City of Tampa must be paid prior to meter set.

SIGNATURE OF OWNER: DATE:

NOTICE: Additional water meters or increase of existing water meter size will require additional Water/Wastewater fees.

FEES

WATER COMMITMENT	WATER	WASTEWATER
		CONNECTION FEE
WATER COMMITMENT EXPIRES UNLESS PAYMENT IS MADE WITHIN 30 DAYS	APPLICATION FEE	APPLICATION FEE
	SECURITY DEPOSIT	SECURITY DEPOSIT
	AID IN CONSTRUCTION FEE	AID IN CONSTRUCTION FEE
	INSTALLATION FEE	WASTEWATER IMPROVEMENT FEE
	CASING	COMPLETED BY:
	DER FEE	
	SERVICE REQUEST NUMBER	TOTAL