



CITY OF TAMPA

Pam Iorio, Mayor

CONTRACT ADMINISTRATION DEPARTMENT

David L. Vaughn, AIA, Director

ADDENDUM NO. 2
DATE: AUGUST 1, 2007

Project: 7-C-15; Cancer Survivor Park Ditch Improvements

Bidders on the above referenced project are hereby notified that the following addendum is made to the Contract Documents. BIDS TO BE SUBMITTED SHALL CONFORM TO THIS NOTICE.

- Item 1: As a clarification, structure S-101 is included in the scope of work for both Alternate bids 1 and 2.
- Item 2: Modify Section 02300; subsection 1.3 to indicate that all density tests will be performed by the City of Tampa's own testing facility.
- Item 3: Modify Section 03300, subsection 1.3 to indicate that all material testing will be performed by the City of Tampa's own testing Facility.
- Item 4: Clarify Section 03410, Part 3, "Field Quality Control". City personnel will perform testing and inspection for quality assurance only. The contractor is responsible for all quality control and any additional testing of his work that he may deem necessary.
- Item 5: Replace drawing C-1 with the attached C-1, dated July 31, 2007; thereby modifying the base bid length of culvert and Alternates 1 and 2 to match the information provided on proposal sheets P-3 and P-4.
- Item 6: As a clarification, refer to sheet A-1, "Plant List", the sunshine mimosa shall be planted @ 18" o.c. each way. The quantities indicated in the schedule are not correct.

This addendum shall be included in and attached to the inside cover of the Contract Documents by and upon which bids are submitted.

All other provisions of the Contract Documents and Specifications not in conflict with this Addendum shall remain in full force and effect.

Questions may be directed to Jim Greiner, P.E.; Telephone (813) 274-8598, fax (813) 274-8080, or e-mail Jim.Greiner@tampagov.net.

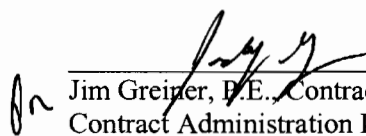
Jim Greiner, P.E., Contract Manager
Contract Administration Department

306 E. Jackson Street, 4N • Tampa, Florida 33602 • (813) 274-8456 • FAX: (813) 274-8080

www.tampagov.net

S. R. 574
MARTIN LUTHER KING JR. BLVD.

S. R. 597
DALE WADSWORTH HIGHWAY

NOTE: ALL DISTURBED AREAS ARE TO BE SODDED.

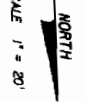

SCALE 1" = 20'

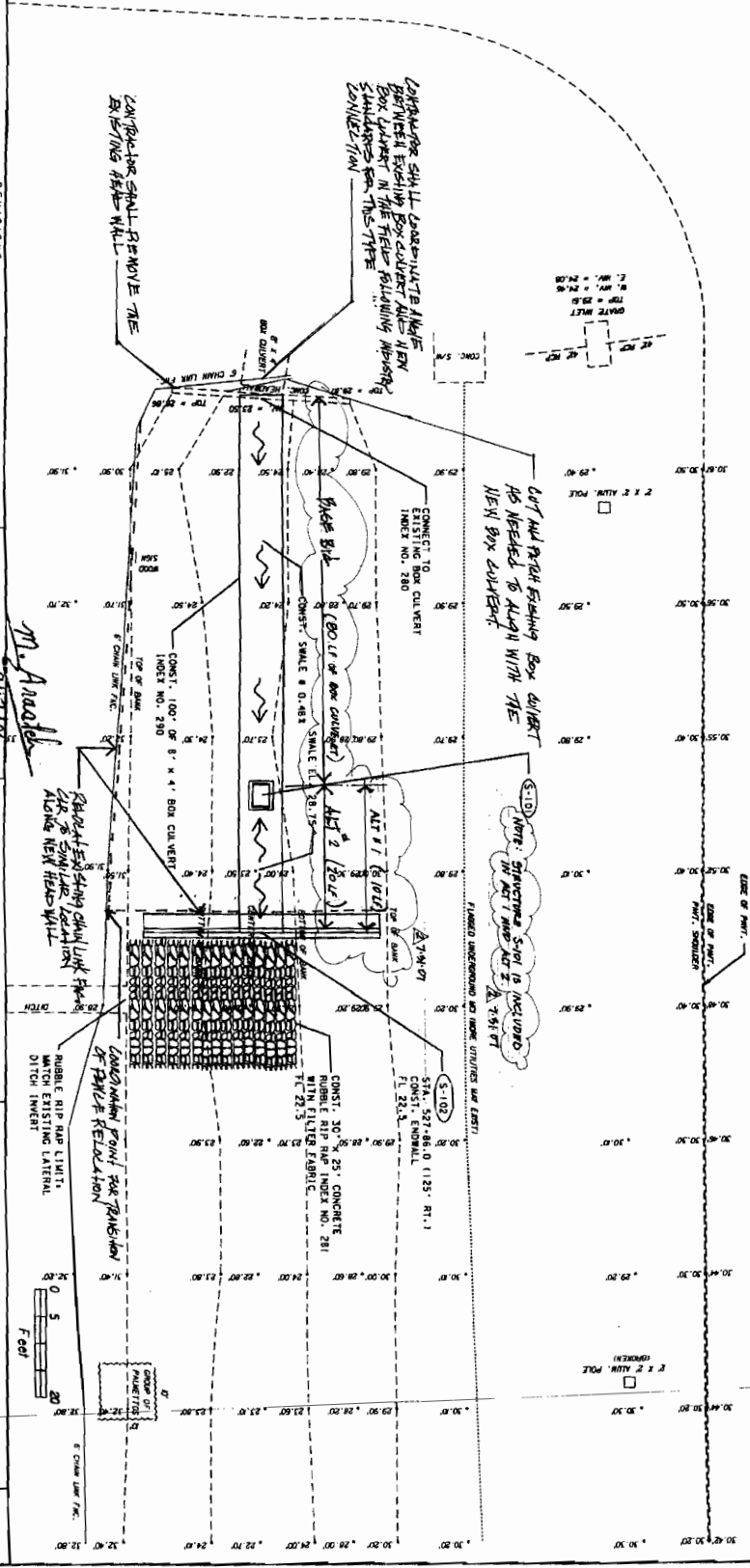

CONTRACTOR SHALL REMOVE THE EXISTING BRICK WALL

CONTRACTOR SHALL CONSTRUCT A NEW BOX ALIGNED IN THE FIELD FOLLOWING NEW BOX CENTERLINE FOR THIS TYPE CONNECTION

CUT AND PATCH EXISTING BOX DUCT AS NEEDED TO ALIGN WITH THE NEW BOX DUCT

NOTE: STRUCTURE SHOWN IS INCORPORATED INTO EXISTING UTILITY LINE CENTERLINE

CONSTRUCTION POINT FOR TRANSITION OF FENCE REDUCTION

RUBBER RIP RAP LIMIT MATCH EXISTING LATERAL DITCH INVERT

M. Anadele
9/12/20

DATE	BY	REVISIONS	DESCRIPTION
7/6/07	CON	A	ISSUE FOR CONSTRUCTION OF BOX DUCT FOR DRIVEWAY

OWNER	ADDRESS	STATE OR TERRITORY	COUNTY	TOWNSHIP	SECTION
DALE WADSWORTH	150 N. WADSWORTH DR., TAMPA, FL 33613	FLORIDA	HILLSBOROUGH		

PROJECT	DEPARTMENT OF TRANSPORTATION
PROJECT NO.	SR 597
PROJECT NAME	HILLSBOROUGH

CANCER SURVIVORS PLAZA
Bar Culvert Extension Plan Sheet

SHEET NO. C-1