

REZONING

GENERAL LOCATION: 5507, 5313 E Broadway; 2006, 2008 54th St

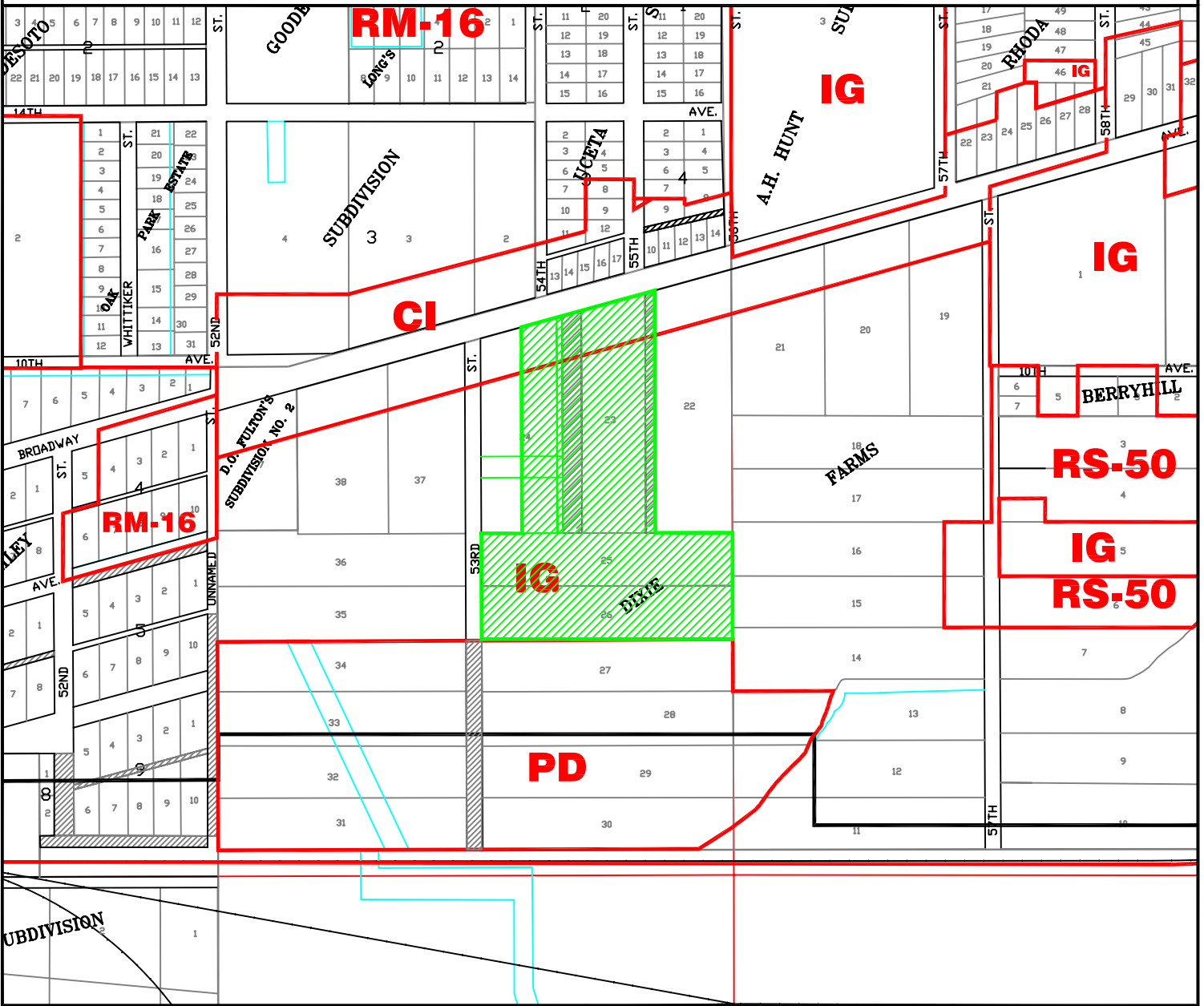

Sec. 15 -T 29 S-R 19 E

Atlas Sheet: H-16

Scale: 1" = 400

FILE NO.: Z08-40

RIGHT OF WAY AND MAPPING
 LAND DEVELOPMENT COORDINATION
 GROWTH MANAGEMENT & DEVELOPMENT SERVICES
 CITY OF TAMPA, FLORIDA

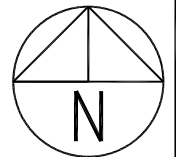

 - REZONING AREA

FROM: IG

TO: PD

- RS-50-RESIDENTIAL SINGLE FAMILY
- RS-60-RESIDENTIAL SINGLE FAMILY
- RS-75-RESIDENTIAL SINGLE FAMILY
- RS-100-RESIDENTIAL SINGLE FAMILY
- RS-150-RESIDENTIAL SINGLE FAMILY
- RM-12-RESIDENTIAL MULTI FAMILY
- RM-16-RESIDENTIAL MULTI FAMILY
- RM-18-RESIDENTIAL MULTI FAMILY
- RM-24-RESIDENTIAL MULTI FAMILY

- RM-35-RESIDENTIAL MULTI FAMILY
- RM-50-RESIDENTIAL MULTI FAMILY
- RM-75-RESIDENTIAL MULTI FAMILY
- RO-RESIDENTIAL OFFICE
- RO-1-RESIDENTIAL OFFICE
- OP-OFFICE PROFESSIONAL
- OP-1-OFFICE PROFESSIONAL
- CN-COMMERCIAL NEIGHBORHOOD
- CG-COMMERCIAL GENERAL

- CI-COMMERCIAL INTENSIVE
- IG-INDUSTRIAL GENERAL
- IH-INDUSTRIAL HEAVY
- PD-PLANNED DEVELOPMENT
- M-AP-AIRPORT COMPATIBILITY
- CBD-CENTRAL BUSINESS DISTRICT
- YC-YBOR CITY HISTORIC DISTRICT
- TQD-TAMPA QUALITY DEVELOPMENT
- CD-CHANNEL DISTRICT
- PP-PUBLIC PARK