



CITY OF TAMPA

Bob Buckhorn, Mayor

CONTRACT ADMINISTRATION DEPARTMENT

David L. Vaughn, AIA, Director

ADDENDUM NO. 1

DATE: December 9, 2014

Contract 14-C-00056; Harbour Island Roadway Surface Replacement

Bidders on the above referenced project are hereby notified that the following addendum is made to the Contract Documents. BIDS TO BE SUBMITTED SHALL CONFORM TO THIS NOTICE.

- Item 1: Replace Proposal page P-3 with the attached Proposal page P-3R
- Item 2: Section 01 10 00 Task Items, page 01 10 00 -7, T.I. 5.1 C. Execution: Delete paragraph 1.
- Item 3: Section 01 45 29 Structural Testing and Inspections, page 01 45 29 – 2, 1.5 Contractor Responsibilities: Delete paragraph A.
- Item 4: Replace Plan Sheets S1.3, S1.4, S1.5, and S2.0 with the attached, revised Plan Sheets S1.3, S1.4, S1.5, and S2.0.
- Item 5: Attached for reference is the pre-bid meeting sign-in sheet.

All other provisions of the Contract Documents and Specifications not in conflict with this Addendum shall remain in full force and effect. Questions are to be e-mailed to ContractAdministration@tampagov.net.

Jim Greiner

Jim Greiner, P.E., Contract Management Supervisor

Project:

**HARBOUR ISLAND
 ROADWAY SURFACE
 REPLACEMENT**

Client:

CITY OF TAMPA

Keyplan:

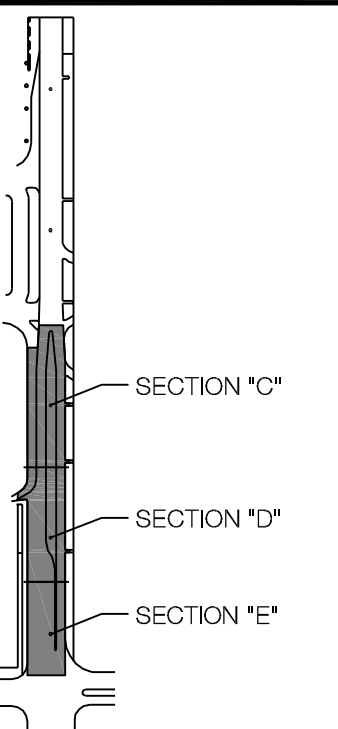

Issues/Revisions:

No.	Date	Description
△	08.DEC.14	ADDENDUM 1

Project Number: M05.10002.01
 Drawn By: RC
 Approved By: WW
 Checked By: EV

Certification Statement:
 TO THE BEST OF THE ENGINEER'S KNOWLEDGE, THE
 PLANS AND SPECIFICATIONS COMPLY WITH THE 2010
 FLORIDA BUILDING CODE.

Seal and Signature:

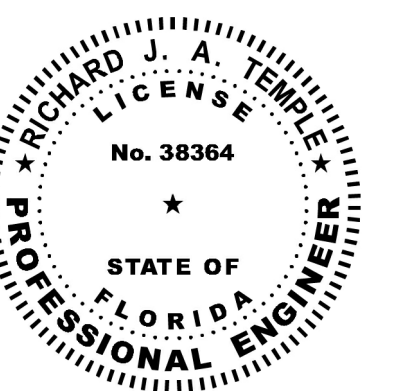

Copyright (c) 2013 by Walter P. Moore and Associates, Inc.

This document and the information herein is the property of Walter P. Moore and Associates, Inc. No part hereof shall be copied, duplicated, distributed, disclosed or used in any extent whatsoever except as expressly authorized by Walter P. Moore and Associates, Inc. Any person, firm, or corporation receiving this document, however obtained, shall by virtue hereof, be deemed to have agreed to the foregoing restrictions and that this document will be held in trust and confidence subject only to the private use expressly authorized by Walter P. Moore and Associates, Inc.

Drawing Title:

**DEMOLITION
 PARTIAL PLANS
 SECTIONS C & D**

Filename:

Sheet No.:

S1.3

NOTE:
 1. REFER TO DESCRIPTION SKETCH PREPARED BY HEIDT & ASSOCIATES, INC. DATED 7/27/97 FOR SPECIFIC INFORMATION ON RIGHT OF WAY.

NOTES:
 1. REMOVE EXISTING CONCRETE TOPPING SLAB PAVERS, EXPANSION JOINT SYSTEMS AND WATERPROOFING MEMBRANE ON STRUCTURAL SLAB (BELOW TOPPING) WITHIN HATCHED AREAS. REFER TO TASK ITEM 2.0.
 2. RECORD DRAWINGS BY HILLER GROUP INDICATE TOPPING SLAB IS 3" THICK MINIMUM AND 9" THICK MAXIMUM. CONTRACTOR SHALL FIELD VERIFY.
 3. CONTRACTOR SHALL TAKE SPECIAL CARE TO NOT DAMAGE STRUCTURAL CONCRETE SLAB DURING DEMOLITION. SEE GENERAL NOTES SECTION II.C.

LEGEND:
 ○ EXISTING STORM DRAIN LEADER BELOW ROADWAY.

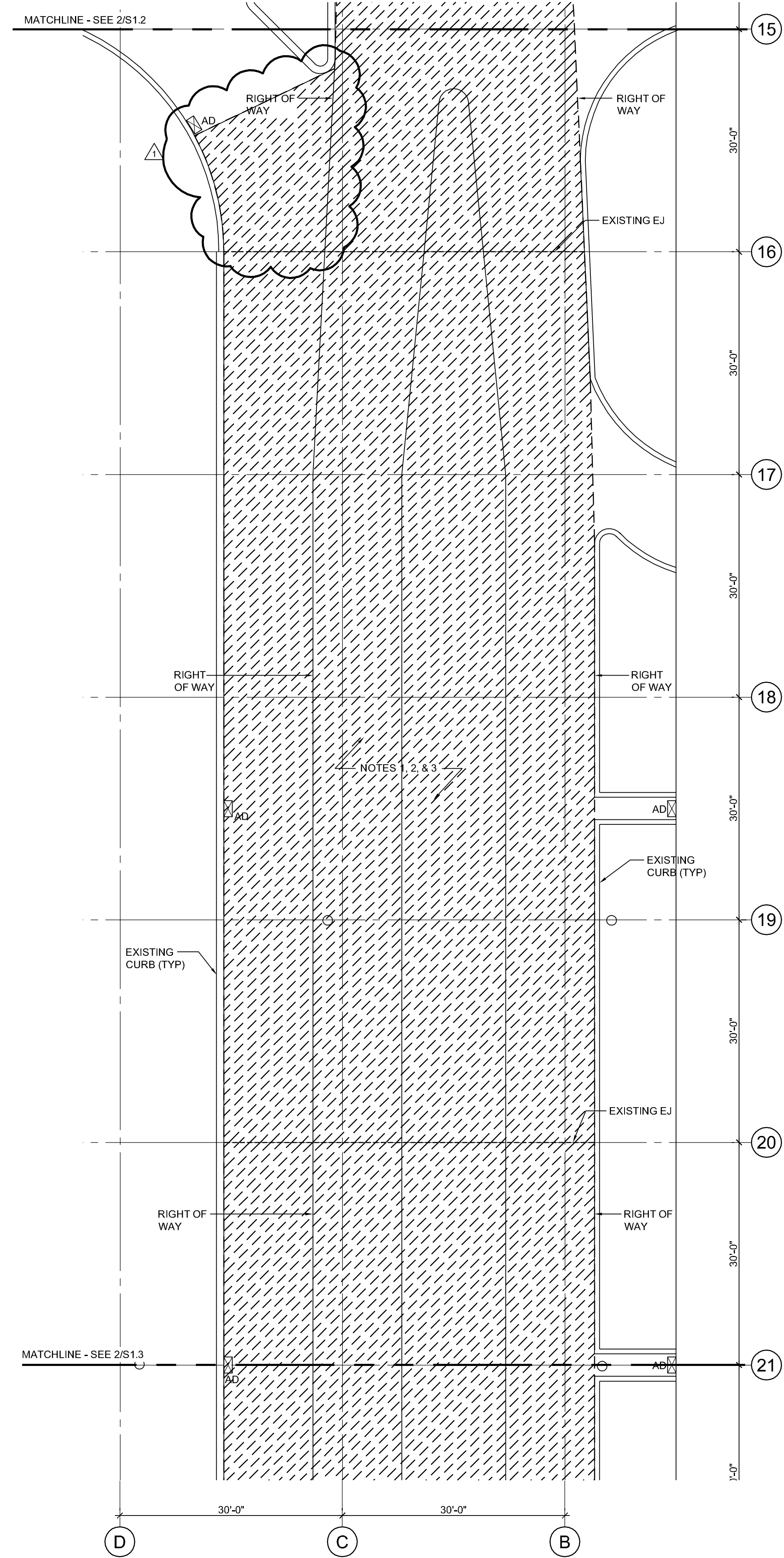
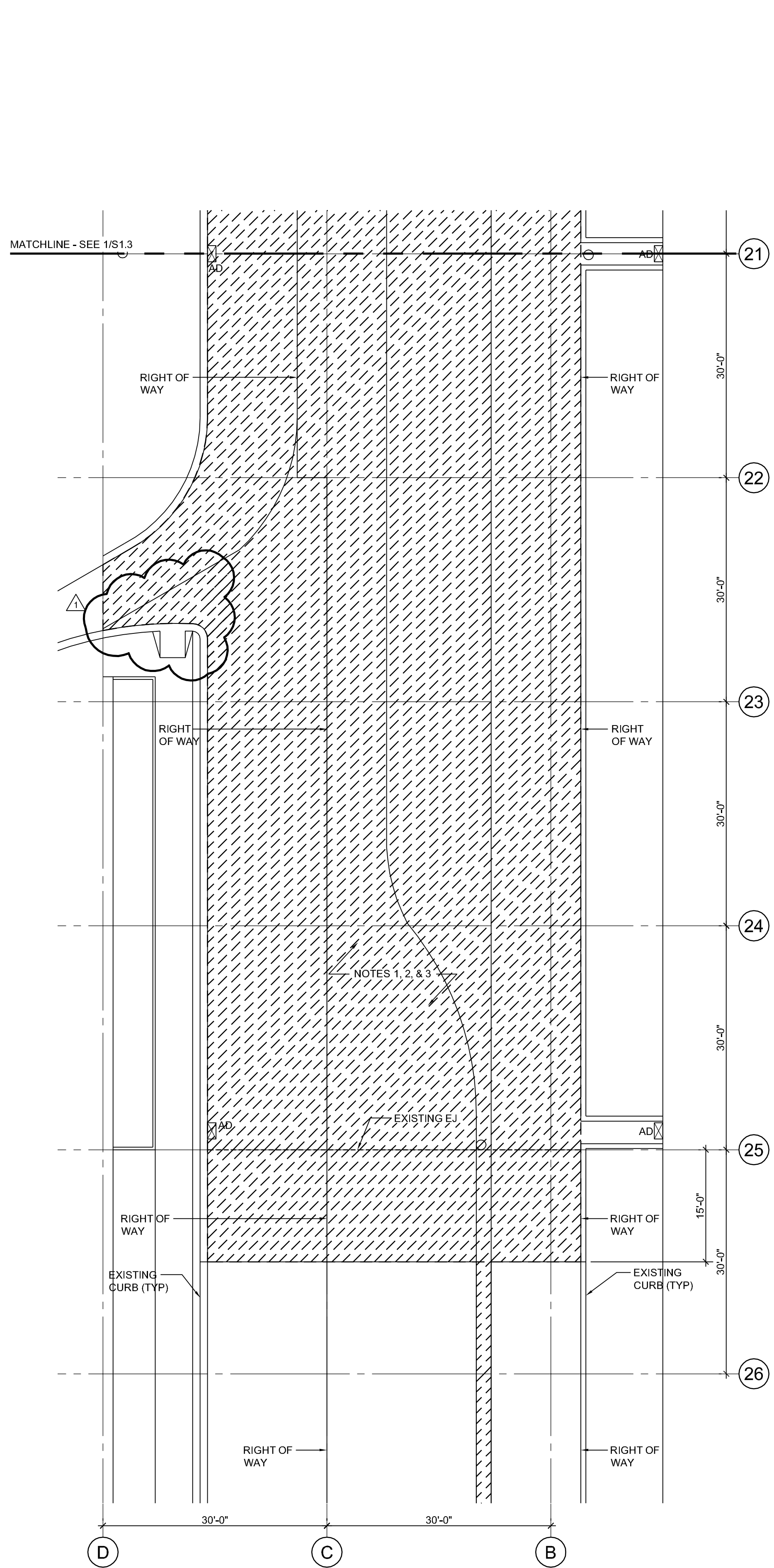

2 DEMOLITION - PARTIAL PLAN SECTION "D"
 NTS

1 DEMOLITION - PARTIAL PLAN SECTION "C"
 NTS

FILE: P:\M05\2010\10002-01\Structural\3-Documentation\Drawings\AutoCAD\Sheets\S1.3.dwg

Project:

**HARBOUR ISLAND
 ROADWAY SURFACE
 REPLACEMENT**

Client:

CITY OF TAMPA

Keyplan:

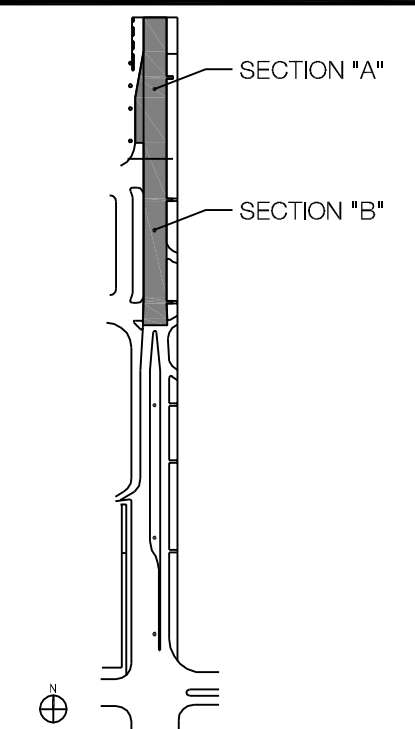

Issues/Revisions:

No.	Date	Description
1	08.DEC.14	ADDENDUM 1

Project Number: M05.10002.01
 Drawn By: RC
 Approved By: WW
 Checked By: EV

Certification Statement:
 TO THE BEST OF THE ENGINEER'S KNOWLEDGE, THE
 PLANS AND SPECIFICATIONS COMPLY WITH THE 2010
 FLORIDA BUILDING CODE.

Seal and Signature:

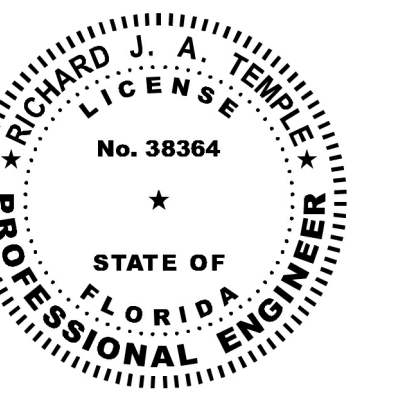

Copyright (c) 2013 by Walter P. Moore and Associates, Inc.

This document and the information herein is the property of Walter P. Moore and Associates, Inc. No part thereof shall be copied, duplicated, distributed, disclosed or used in any extent whatsoever except as expressly authorized by Walter P. Moore and Associates, Inc. Any person, firm, or corporation receiving this document, however obtained, shall by virtue hereof, be deemed to have agreed to the foregoing restrictions and that this document will be held in trust and confidence subject only to the private use expressly authorized by Walter P. Moore and Associates, Inc.

Drawing Title:

**REPLACEMENT
 PARTIAL PLANS
 SECTIONS A & B**

Filename:

Sheet No.:

NOTE:
 1. REFER TO DESCRIPTION SKETCH PREPARED BY HEIDT & ASSOCIATES, INC. DATED 7/27/97 FOR SPECIFIC INFORMATION ON RIGHT OF WAY.

- NOTES:
- CONTRACTOR SHALL INSTALL NEW CONCRETE TOPPING SLAB, EXPANSION JOINT SYSTEMS, EPOXY POLYMER COATING WATERPROOFING MEMBRANE AND CONCRETE PENETRATING SEALER WITHIN SHADED/HATCHED AREAS IN ACCORDANCE WITH ALL REQUIREMENTS OF STRUCTURAL DESIGN DOCUMENTS. REFER TO TASK ITEMS 3.0, 3.0A, 4.0, 5.0, AND 6.0.
 - SEE DETAIL 1/S2.2 FOR TYPICAL CONTROL AND CONSTRUCTION JOINTS IN TOPPING SLAB.
 - SEE DETAIL 2/S2.2 FOR TYPICAL CLEAR CONCRETE COVER REQUIREMENTS.
 - CONTROL JOINT AND CONSTRUCTION JOINT LAYOUT TO BE AS SHOWN ON PLANS.
 - EXISTING AREA DRAINS IN AREA OF TOPPING SLAB REPLACEMENT SHALL REMAIN. CREATE SEALED JOINT IN SURFACE OF NEW TOPPING AT INTERFACE WITH AREA DRAINS.
 - DRILL TWO (2) ONE INCH DIAMETER HOLES IN EXISTING AREA DRAIN DOWNSPOUT AT TOP OF STRUCTURAL SLAB AND WRAP DOWNSPOUT WITH FILTER FABRIC.
 - NEW DRAINS SHALL BE ZURN Z531 DECK DRAINS OR ENGINEER-APPROVED EQUAL INSTALLED AT STRUCTURAL SLAB LEVEL WITH 3" DIAMETER DOWNSPOUT CONNECTED TO EXISTING STORMWATER DRAINAGE SYSTEM.
 - CONTRACTOR SHALL SUBMIT DECK DRAIN SHOP DRAWINGS INDICATING LOCATIONS OF DRAINS AND SHALL SUBMIT DRAIN PRODUCT DATA.

△ AESTHETIC SURFACE DESIGN REQUIREMENTS.
 1. ACCENT BAND TO BE PROVIDED BETWEEN EXISTING COLORED STAMPED CONCRETE AND ADJACENT PROPOSED UNCOLORED CONCRETE.
 2. EXISTING SPECIFICATIONS TO NOT BE RE-CONSTRUCTED.
 3. EXISTING PAVERS IN THE MEDIAN ARE NOT TO BE REPLACED. THESE AREAS WILL RECEIVE SPECIFIED CONCRETE TOPPING SLAB ONLY.
 4. BROOM FINISH ALL CONCRETE TOPPING SLAB FINISHES. REFER TO SPECIFICATIONS.
 5. CONTRACTOR SHALL PREPARE 2 FT BY 2 FT MOCKUP SAMPLE FOR EACH TYPE OF STAMPED AND/OR COLORED CONCRETE FOR CITY, HCSA AND ENGINEER APPROVAL PRIOR TO COMMENCING WITH PLACEMENT OF NEW TOPPING SLAB.

LEGEND:
 ○ EXISTING STORM DRAIN LEADER BELOW ROADWAY.

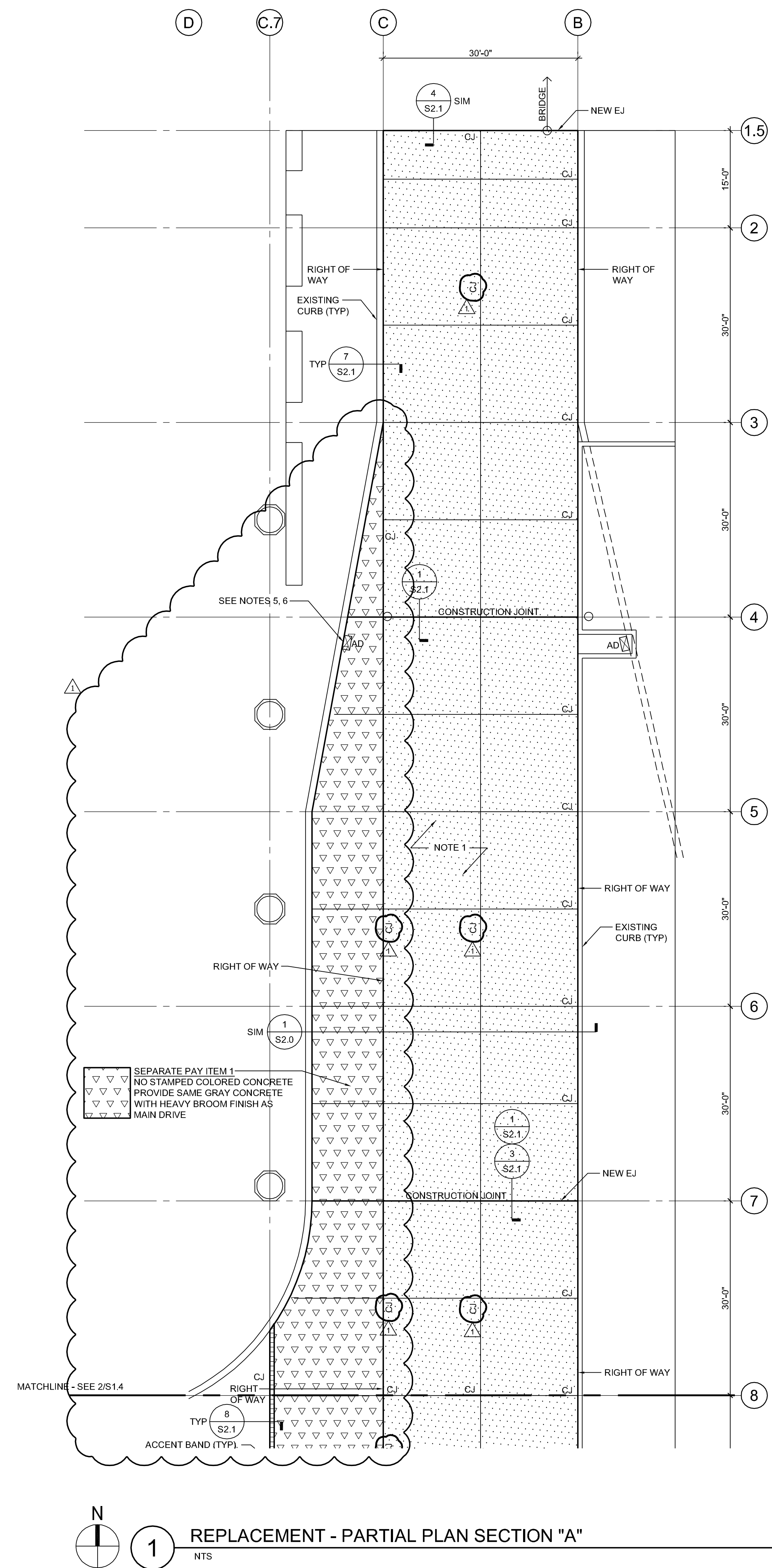

SEPARATE PAY ITEM 1
 NO STAMPED COLORED CONCRETE
 PROVIDE SAME GRAY CONCRETE
 WITH HEAVY BROOM FINISH AS
 MAIN DRIVE

1 REPLACEMENT - PARTIAL PLAN SECTION "A"
 NTS

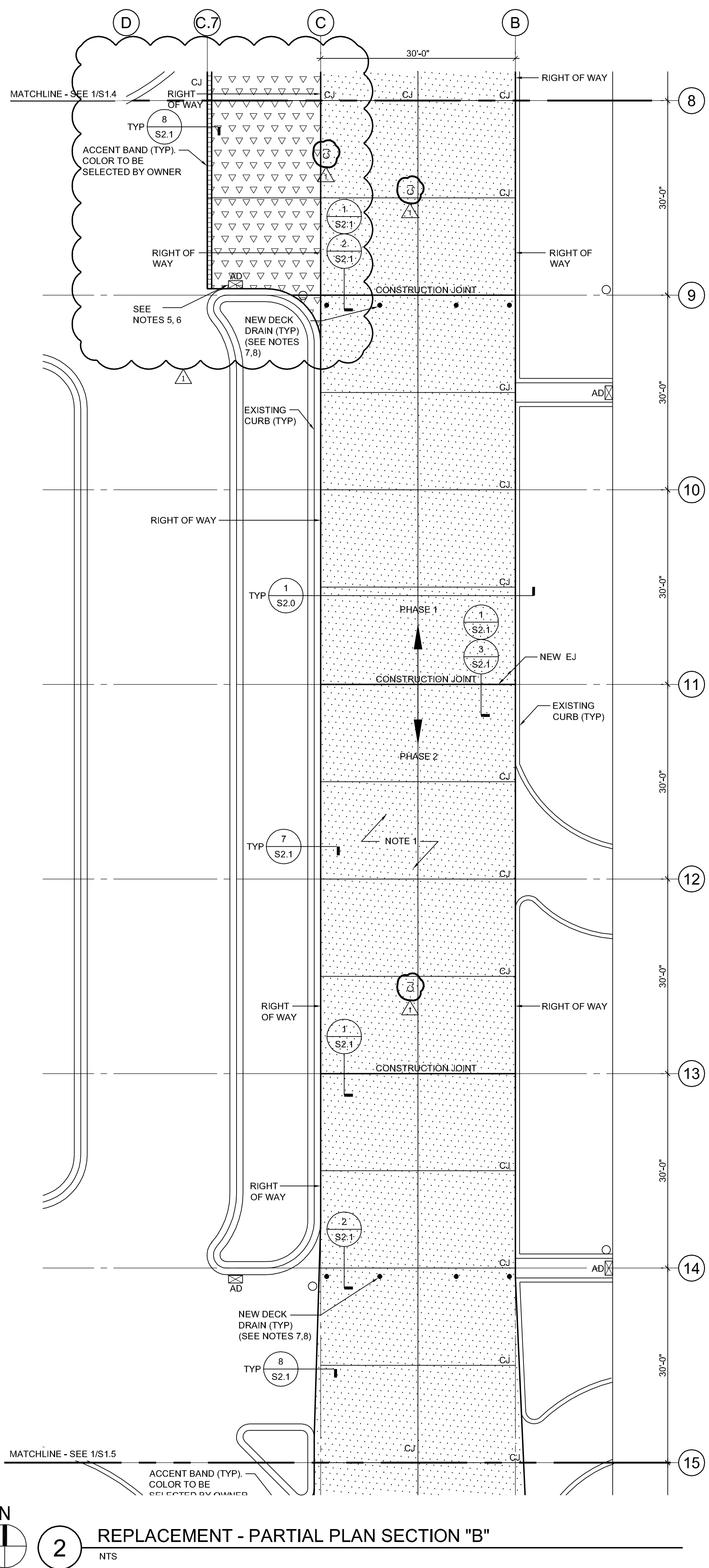

2 REPLACEMENT - PARTIAL PLAN SECTION "B"
 NTS

Project:

**HARBOUR ISLAND
 ROADWAY SURFACE
 REPLACEMENT**

Client:

CITY OF TAMPA

Keyplan:

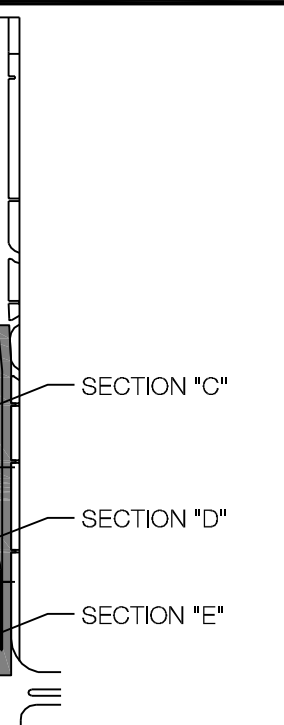

Issues/Revisions:

No.	Date	Description
1	08.DEC.14	ADDENDUM 1

Project Number: M05.10002.01
 Drawn By: RC
 Approved By: WW
 Checked By: EV

Certification Statement:
 TO THE BEST OF THE ENGINEER'S KNOWLEDGE, THE
 PLANS AND SPECIFICATIONS COMPLY WITH THE 2010
 FLORIDA BUILDING CODE.

Seal and Signature:

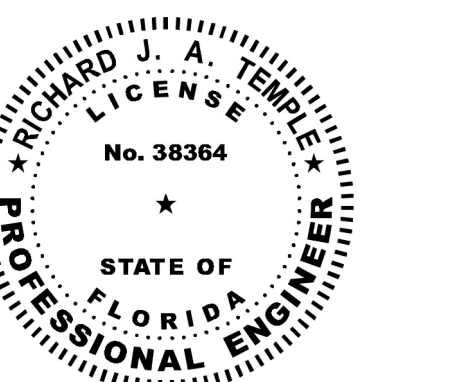

Copyright (c) 2013 by Walter P. Moore and Associates, Inc.

This document and the information herein is the property of Walter P. Moore and Associates, Inc. No part hereof shall be copied, duplicated, distributed, disclosed or used to any extent whatsoever except as expressly authorized by Walter P. Moore and Associates, Inc. Any person, firm, or corporation receiving this document, however obtained, shall by virtue hereof, be deemed to have agreed to the foregoing restrictions and that this document will be held in trust and confidence subject only to the private use expressly authorized by Walter P. Moore and Associates, Inc.

Drawing Title:

**REPLACEMENT
 PARTIAL PLANS
 SECTIONS C & D**

Filename:

Sheet No.:

NOTE:
 1. REFER TO DESCRIPTION SKETCH PREPARED BY HEIDT & ASSOCIATES, INC. DATED 7/27/97 FOR SPECIFIC INFORMATION ON RIGHT OF WAY.

- NOTES:
- CONTRACTOR SHALL INSTALL NEW CONCRETE TOPPING SLAB, EXPANSION JOINT SYSTEMS, EPOXY POLYMER COATING WATERPROOFING MEMBRANE AND CONCRETE PENETRATING SEALER WITHIN SHADED/MATCHED AREAS IN ACCORDANCE WITH ALL REQUIREMENTS OF STRUCTURAL DESIGN DOCUMENTS. REFER TO TASK ITEMS 3.0, 3.0A, 4.0, 5.0, AND 6.0.
 - SEE DETAIL 1/S2.2 FOR TYPICAL CONTROL AND CONSTRUCTION JOINTS IN TOPPING SLAB.
 - SEE DETAIL 2/S2.2 FOR TYPICAL CLEAR CONCRETE COVER REQUIREMENTS.
 - CONTROL JOINT AND CONSTRUCTION JOINT LAYOUT TO BE AS SHOWN ON PLANS.
 - EXISTING AREA DRAINS IN AREA OF TOPPING SLAB REPLACEMENT SHALL REMAIN. CREATE SEALED JOINT IN SURFACE OF NEW TOPPING AT INTERFACE WITH AREA DRAINS.
 - DRILL TWO (2) ONE INCH DIAMETER HOLES IN EXISTING AREA DRAIN DOWNSPOUT AT TOP OF STRUCTURAL SLAB AND WRAP DOWNSPOUT WITH FILTER FABRIC.
 - NEW DRAINS SHALL BE ZURN Z531 DECK DRAINS OR ENGINEER-APPROVED EQUAL INSTALLED AT STRUCTURAL SLAB LEVEL WITH 3" DIAMETER DOWNSPOUT CONNECTED TO EXISTING STORMWATER DRAINAGE SYSTEM. CONTRACTOR SHALL SUBMIT DECK DRAIN SHOP DRAWINGS INDICATING LOCATIONS OF DRAINS AND SHALL SUBMIT DRAIN PRODUCT DATA.

1. AESTHETIC SURFACE DESIGN REQUIREMENTS:
 ACCENT BAND TO BE PROVIDED BETWEEN EXISTING COLORED STAMPED CONCRETE AND ADJACENT PROPOSED UNCOLORED CONCRETE.
 EXISTING STORM DRAINS ARE NOT TO BE RE-CONSTRUCTED.
 3. EXISTING PAVERS IN THE MEDIAN ARE NOT TO BE REPLACED. THESE AREAS WILL RECEIVE SPECIFIED CONCRETE TOPPING SLAB ONLY.
 4. BROOM FINISH ALL CONCRETE TOPPING SLAB FINISHES. REFER TO SPECIFICATIONS.
 5. CONTRACTOR SHALL PREPARE 2 FT BY 2 FT MOCKUP SAMPLE FOR EACH TYPE OF STAMPED AND/OR COLORED CONCRETE FOR CITY, HICSA AND ENGINEER APPROVAL PRIOR TO COMMENCING WITH PLACEMENT OF NEW TOPPING SLAB.

LEGEND:
 ○ EXISTING STORM DRAIN LEADER BELOW ROADWAY.

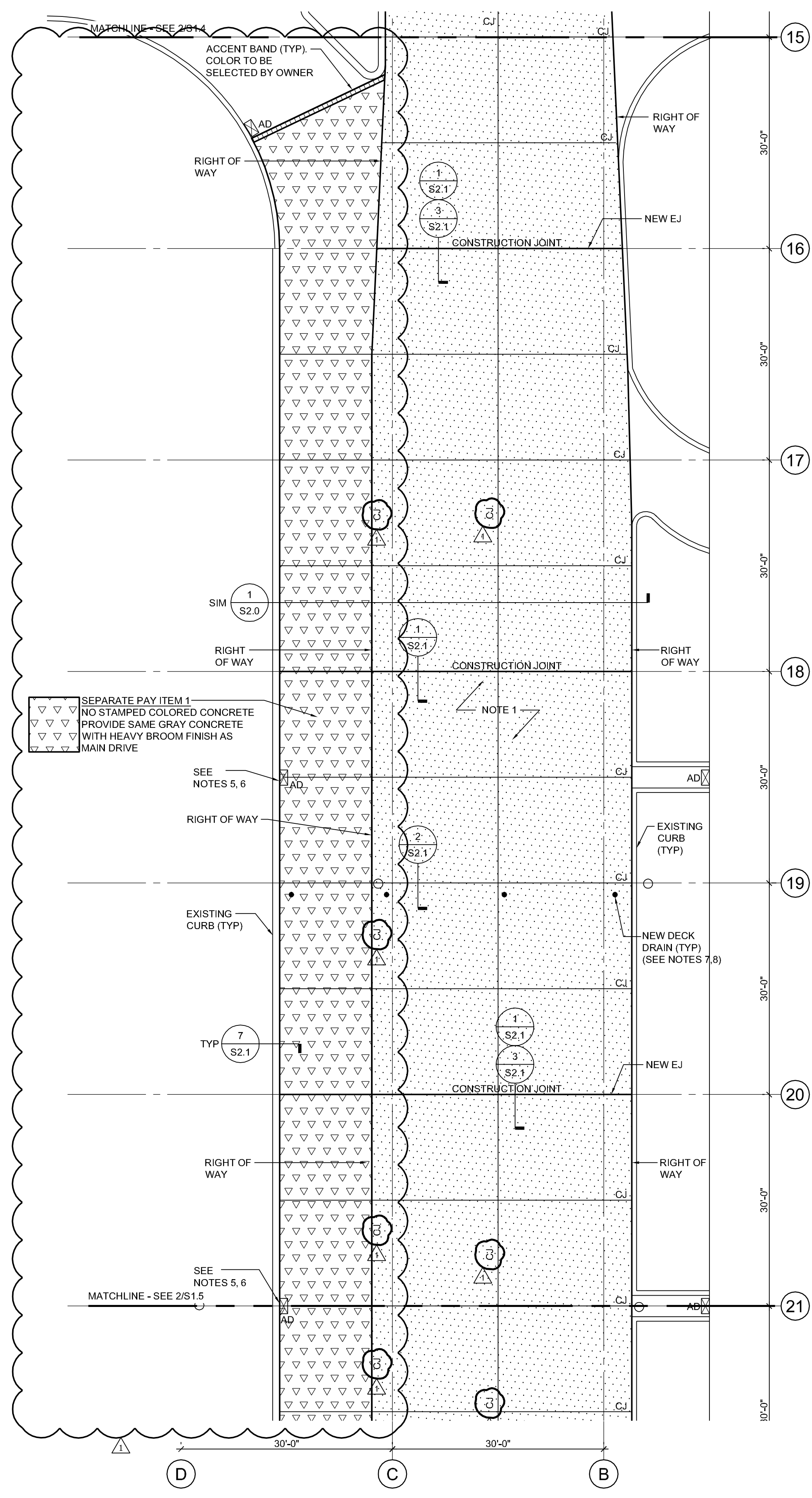
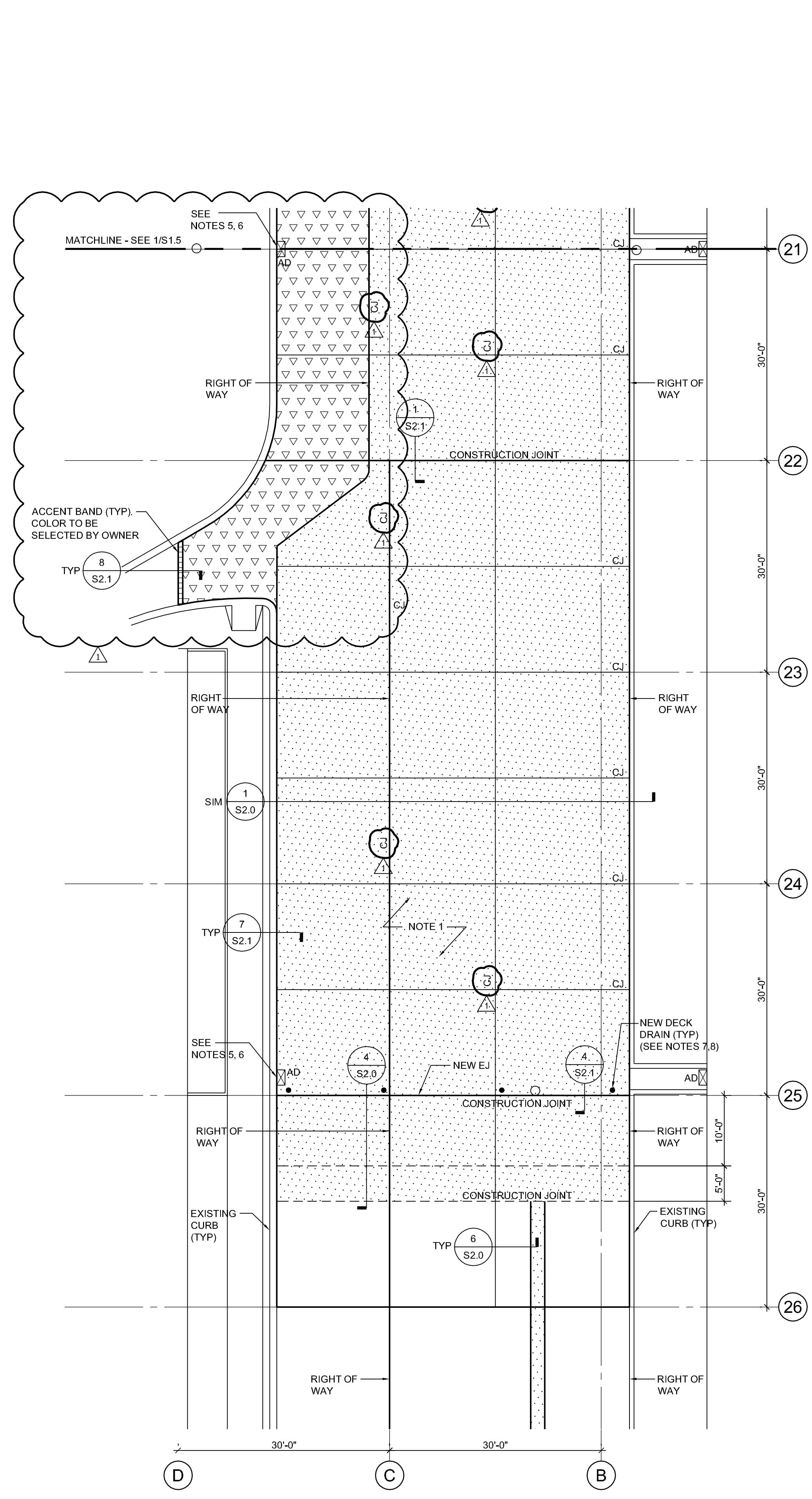

2 REPLACEMENT - PARTIAL PLAN SECTION "D"
 NTS

1 REPLACEMENT - PARTIAL PLAN SECTION "C"
 NTS

Project:

HARBOUR ISLAND
ROADWAY SURFACE
REPLACEMENT

Client:

CITY OF TAMPA

Keyplan:

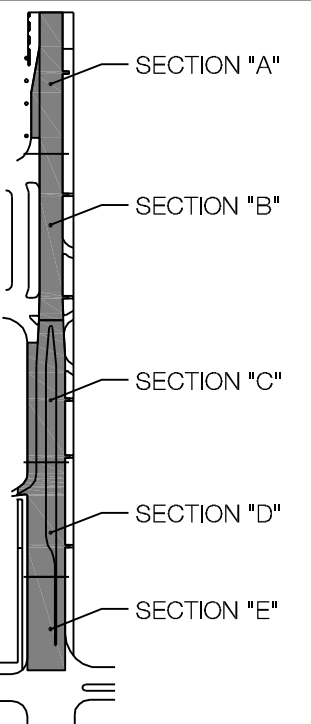

Issues/Revisions:

No.	Date	Description
Δ	08.DEC.14	ADDENDUM 1

Project Number: M05.10002.01
Approved By: WW
Drawn By: RC
Checked By: EV

Certification Statement:
TO THE BEST OF THE ENGINEER'S KNOWLEDGE, THE PLANS AND SPECIFICATIONS COMPLY WITH THE 2010 FLORIDA BUILDING CODE.

Seal and Signature:

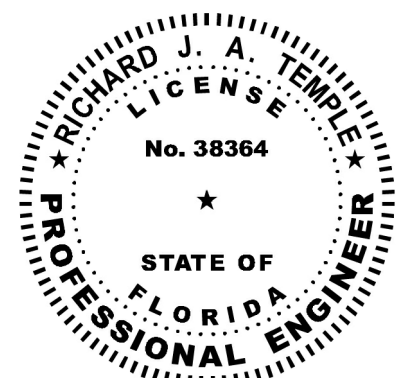

Copyright (c) 2013 by Walter P. Moore and Associates, Inc.
This document and the information herein is the property of Walter P. Moore and Associates, Inc. No part thereof shall be copied, duplicated, distributed, disclosed or used to any extent whatsoever except as expressly authorized by Walter P. Moore and Associates, Inc. Any person, firm, or corporation receiving this document, however obtained, shall by virtue hereof, be deemed to have agreed to the foregoing restrictions and that this document will be held in trust and confidence subject only to the private use expressly authorized by Walter P. Moore and Associates, Inc.

Drawing Title:

SECTIONS
& DETAILS

Filename:
Sheet No.:

S2.0

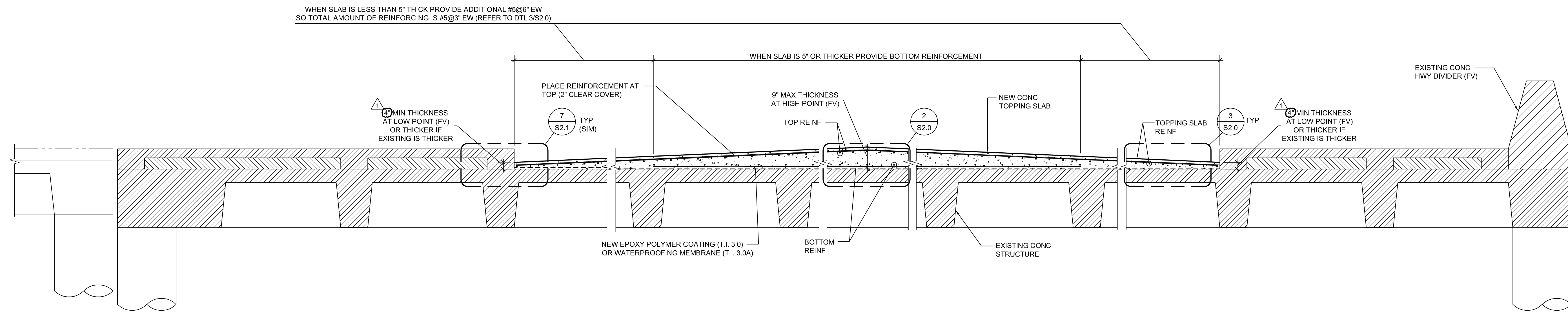

1 ROADWAY CROSS SECTION
NTS

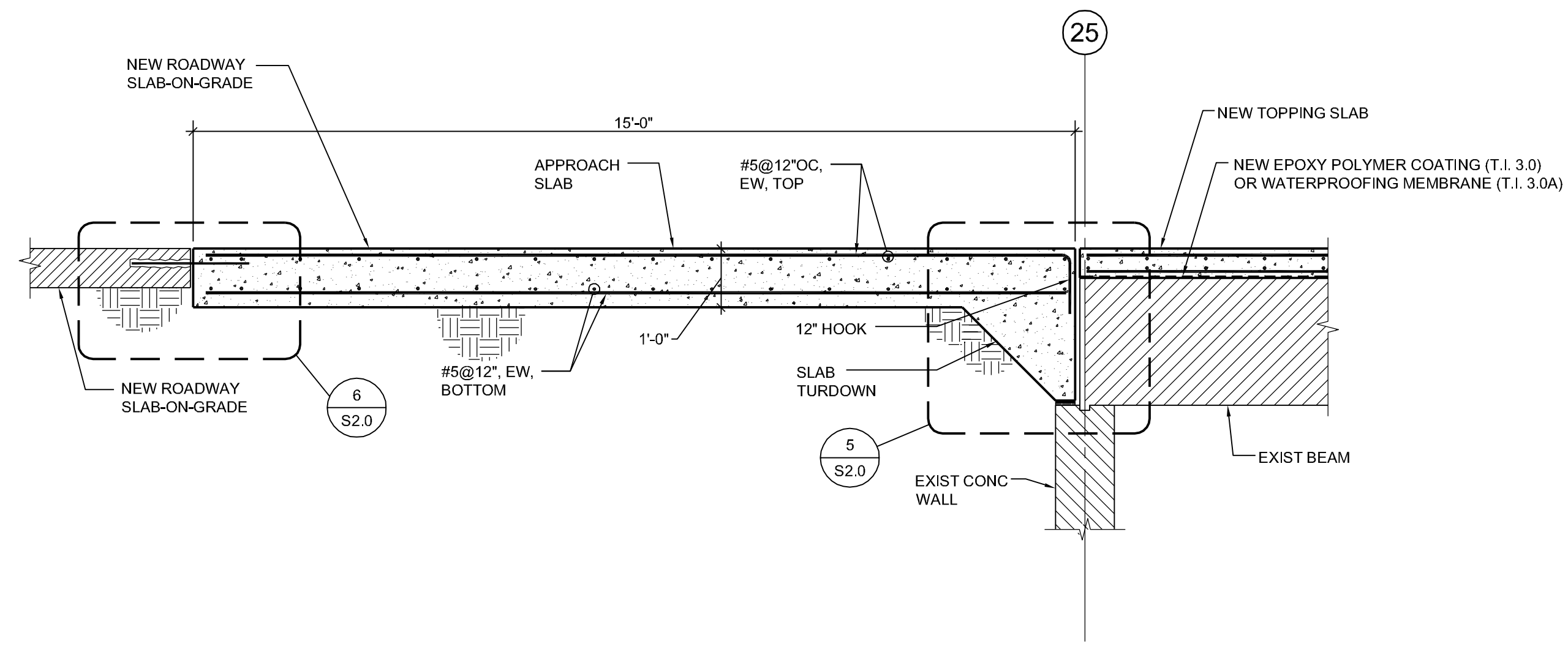

4 APPROACH SLAB
NTS

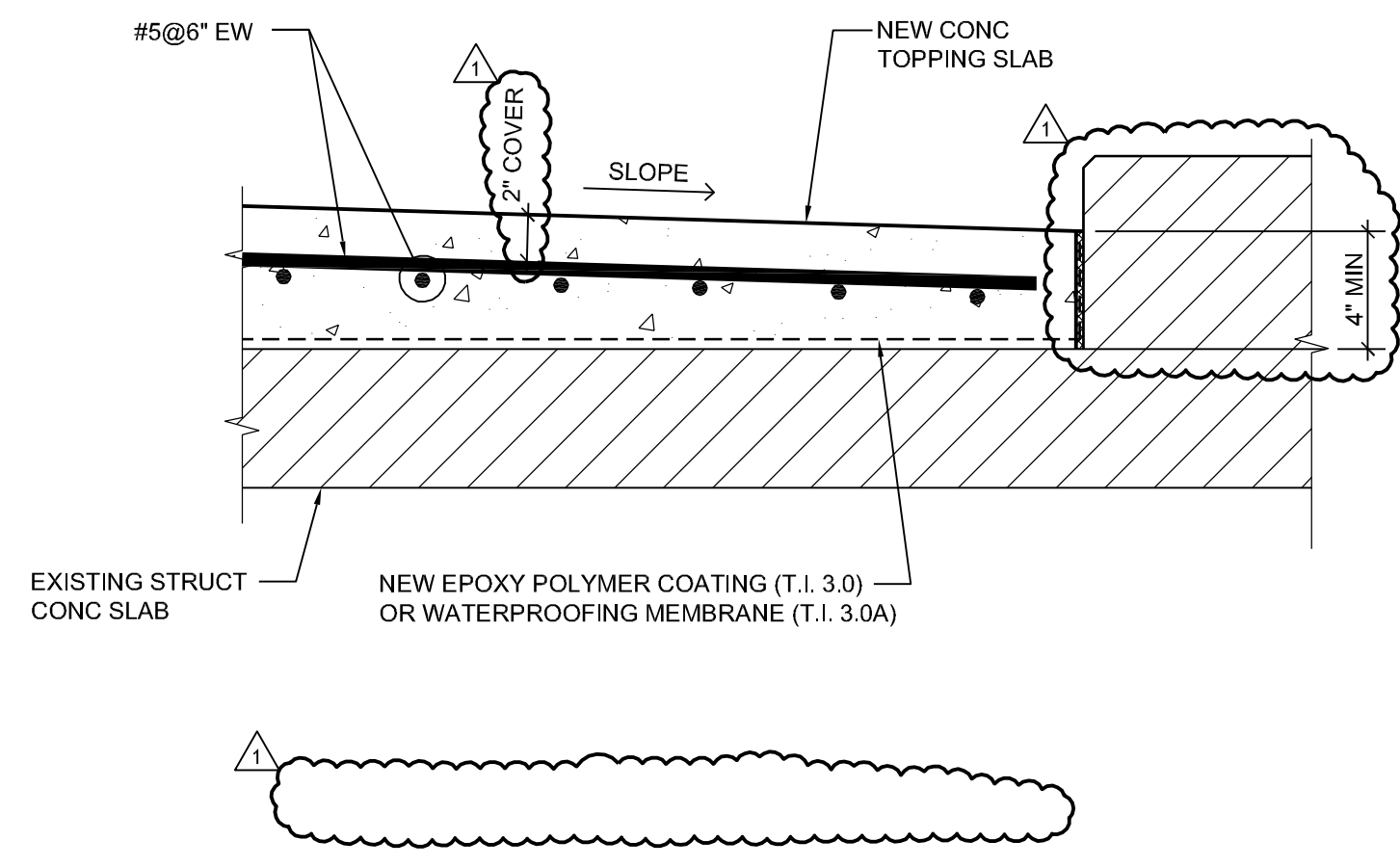

3 NEW TOPPING SLAB WITH ONE REINFORCEMENT LAYER
NTS

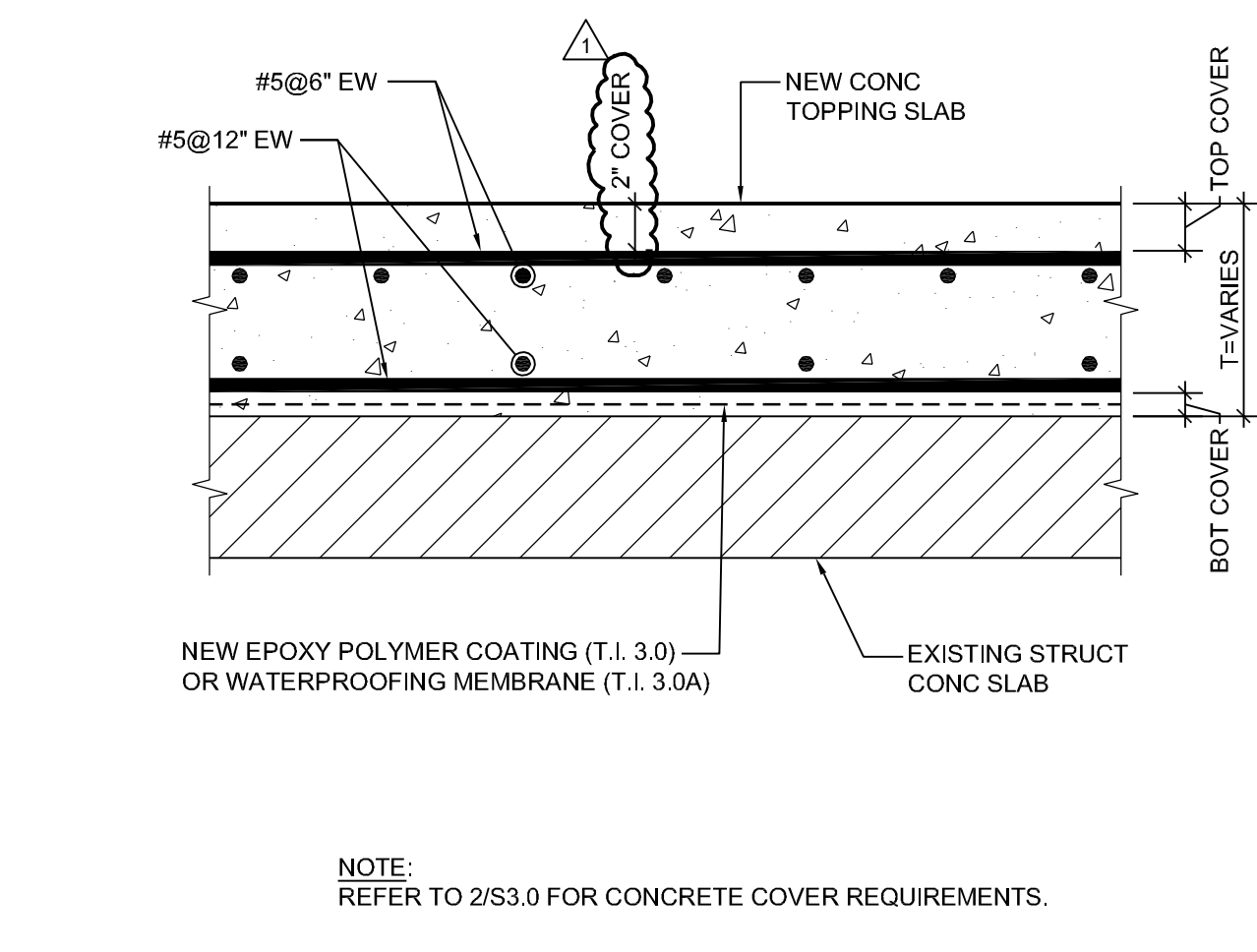

2 NEW TOPPING SLAB WITH 2 REINFORCEMENT LAYERS
NTS

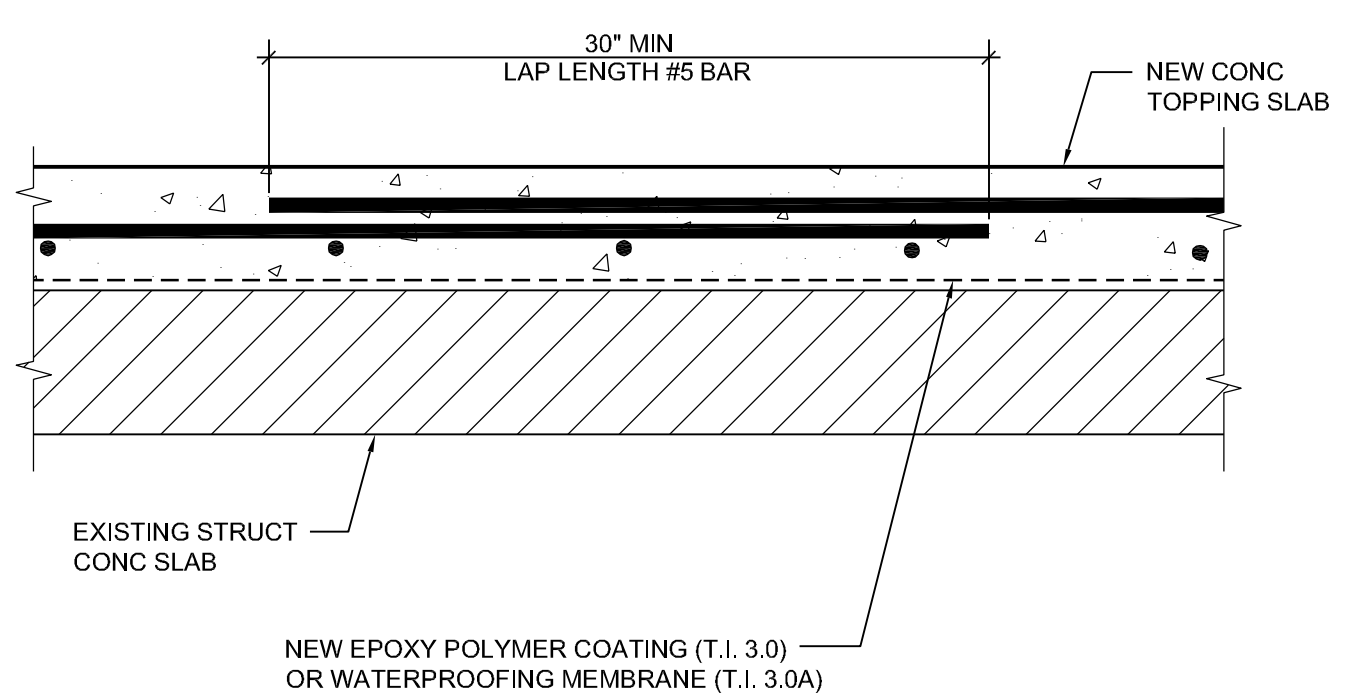

7 TYPICAL LAP LENGTH
NTS

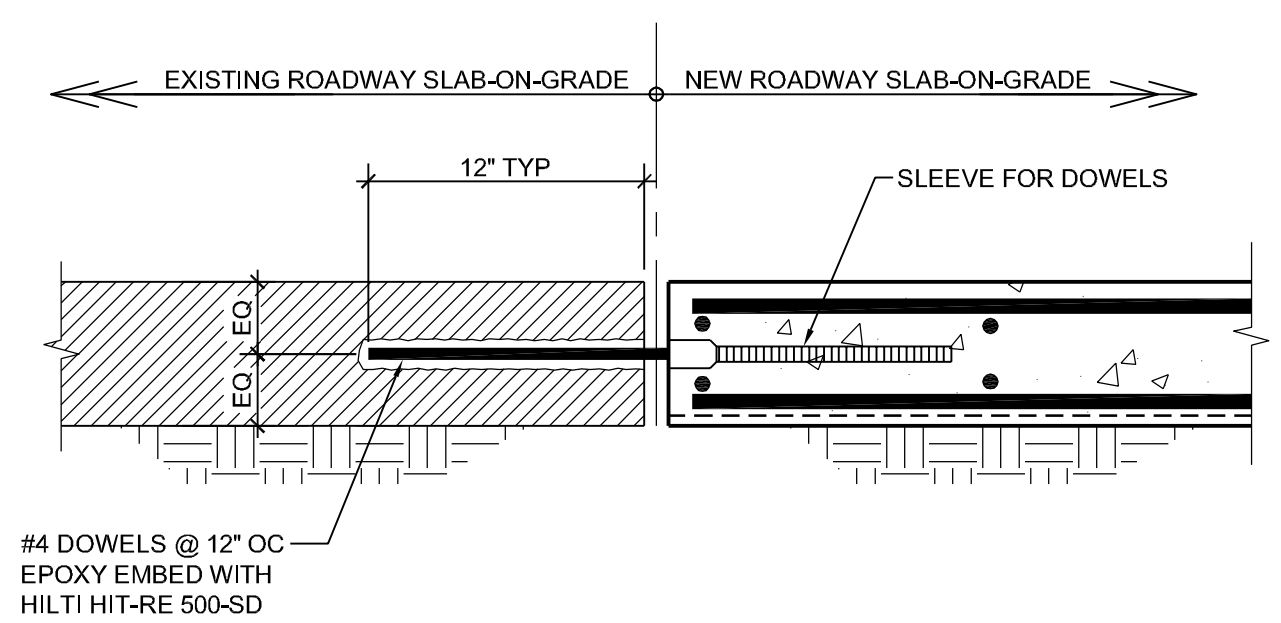

6 SLAB TRANSITION
NTS

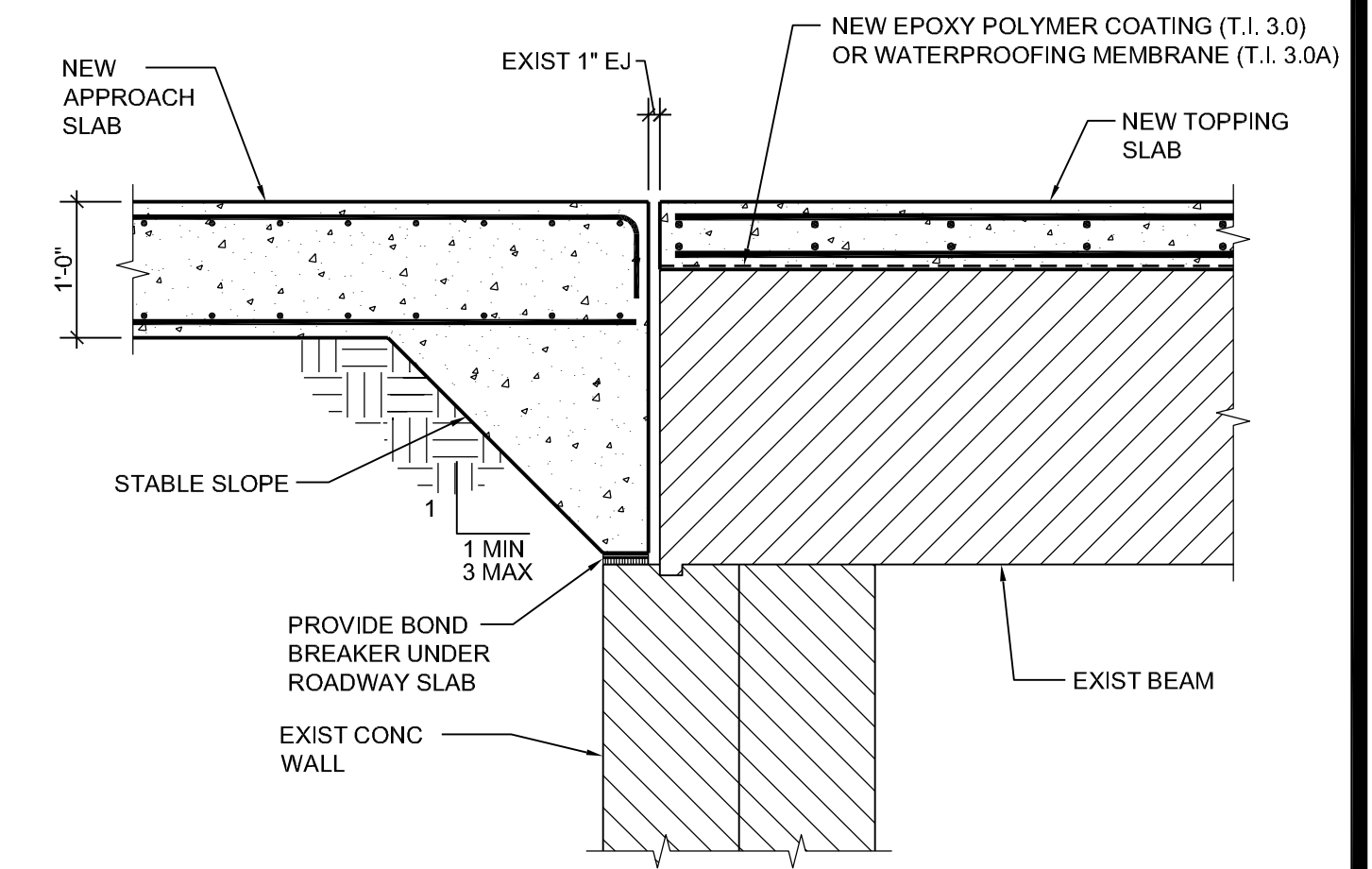

5 APPROACH SLAB - EDGE AT EXISTING BASEMENT WALL
NTS

CONTRACT 14-C-00056; HARBOUR ISLAND ROADWAY SURFACE REPLACEMENT - PRE-BID MEETING 12/02/2014, 2:00 P.M.

E-Mail to Register as a Plan Holder and E-Mail All Questions to; ContractAdministration@tampagov.net

Sign-In Sheet Please Print

City of Tampa, Contract Administration Department

	Name	Organization	E-Mail OR Phone
1	Jim Greiner, PE	Tampa Contract Administration Dept.	Jim.Greiner@tampagov.net
2	Kurt Keith	Pepper Contracting	KURTKEITH@PEPPERCONTRACTING.COM
3	John Kindler	Restacon	JKindler@restacon.com
4	Dawlin Howell	Restacon Corporation	Dhowell@restacon.com
5	Joe Minich	AJAX PAVING	Jminich@ajaxpaving.com
6	David M. Smith	Starns Weaver Mills	dsmith@starnsweaver.com
7	FRANK WOODARD	FRANK COT - CTD	FRANK.WOODARD@TAMPALIA.NET
8	LES MOUZON	TAGARELLI CONSTE.	LES@TAGARELLI.COM
9	RICHARD TEMPLE	WALTER P MOORE	RTEMPLE@WALTERAMORE.COM
10			
11			
12			
13			
14			
15			
16			
17			
18			
19			
20			
21			
22			
23			
24			
25			
26			
27			
28			
29			
30			
31			
32			
33			
34			
35			
36			