

PROJECT LIMIT LINES

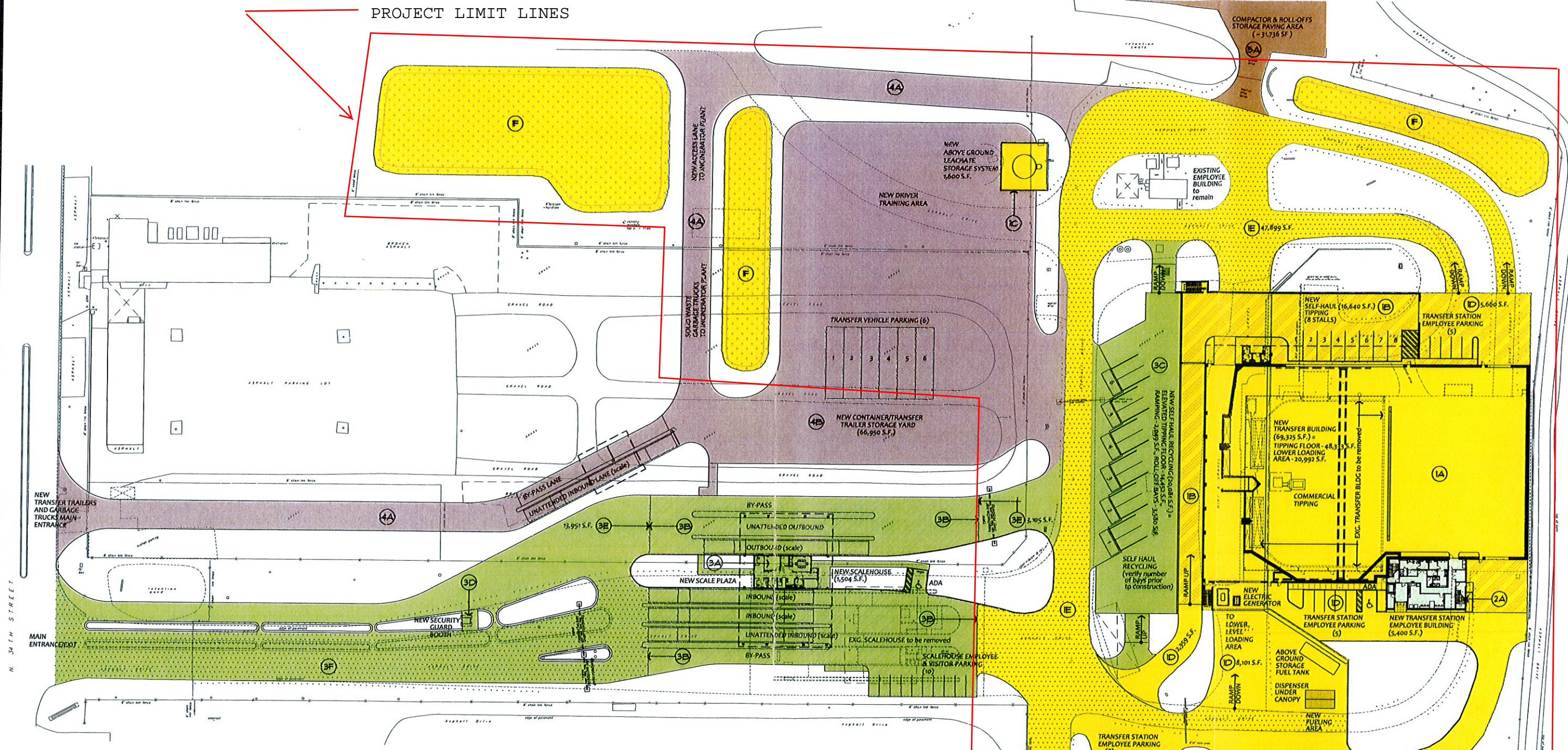

CONSTRUCTION PHASING LEGEND

PHASE - 1	PHASE - 2	PHASE - 3	PHASE - 4	PHASE - 5
<p>(1A) TRANSFER BUILDING - 69,325 S.F. • COMMERCIAL TIPPING FLOOR AND LOWER LEVEL LOADING AREA</p> <p>(1B) RESIDENT SELF HAUL - 16,640 S.F. • RESIDENT TIPPING FLOOR w/ 8-STALLS AND RAMP APPROACH TO THE WEST OF TRANSFER BUILDING</p> <p>(1C) ABOVE GROUND LEACHATE STORAGE SYSTEM - 1,600 S.F.</p> <p>(1D) NEW PAVEMENT - 40,363 S.F.</p> <p>(1E) EXISTING ROADS TO REMAIN (RE-SURFACE) - 41,899 S.F.</p> <p>(1F) NEW PONDS (3 TOTAL) - 40,223 S.F.</p>	<p>(2A) TRANSFER STATION EMPLOYEE BUILDING - 5,400 S.F. • 2-STORY STRUCTURE</p>	<p>(3A) SCALEHOUSE - 15,04 S.F. • 1-STORY STRUCTURE w/ (8,880 S.F.) OVERHEAD CANOPY SYSTEM</p> <p>(3B) SCALE PLAZA - 33,411 S.F. • 3-INBOUND LANES w/ 2-ABOVE GROUND SCALES, 2-OUTBOUND LANES w/ 1-ABOVE GROUND SCALE and 2 BY-PASS LANES</p> <p>(3C) SELF HAUL RECYCLING - 20,281 S.F. • 6-BAY 'Z' WALL ARRANGEMENT FOR ROLL-OFF DUMPSTERS, INCLUDES LEACHATE COLLECTION SYSTEM</p> <p>(3D) SECURITY GUARD BOOTH - 220 S.F.</p> <p>(3E) NEW PAVEMENT - 17,056 S.F.</p>	<p>(4A) ACCESS ROADS TO INCINERATOR PLANT - 32,331 S.F. • INCLUDES ONE UNATTENDED INBOUND LANE w/ ABOVE GROUND SCALE, ADJACENT BY-PASS LANE AND (1656 S.F.) OVERHEAD CANOPY SYSTEM</p> <p>(4B) CONTAINER/TRANSFER TRAILER STORAGE YARD - 66,950 S.F. • 6-PARKING STALLS w/ LEACHATE COLLECTION SYSTEM</p> <p>(4C) NEW DRIVER TRAINING AREA - 1,600 S.F.</p> <p>(4D) NEW CONTAINER/TRANSFER TRAILER STORAGE YARD - 66,950 S.F.</p> <p>(4E) EXISTING ROADS TO REMAIN (RE-SURFACE) - 23,635 S.F.</p>	<p>(5A) EXISTING COMPACTOR and ROLL-OFF STORAGE AREA - 31,736 S.F.</p> <p>(5B) EXISTING CART MAINTENANCE AREA - 64,806 S.F.</p>

LEGEND

- EXISTING PAVEMENT TO BE RE-SURFACED
- PROPOSED POND AREA
- NEW CONCRETE PAVEMENT

NOTE: ALL NEW PAVEMENT NOT SHOWN AS CONCRETE ON THE SITE PLAN SHALL BE DESIGNATED AS NEW ASPHALT PAVEMENT.

SCALE: 1" = 40'

0 20' 40' 100'

NORTH